

Option Switch Settings



Some of the interface units used between a media gateway and other types of equipment require specific option switch settings for each application.

- [Printer Option Settings](#)
- [G600 Media Gateway Carrier ID Address](#)
- [TN760D Tie Trunk Circuit Pack Option Settings](#)
- [TN464/2464 Option Settings](#)

Refer to the user's guide for each type of equipment for information on how to locate and set the option switches.

Printer Option Settings

Printers can be used as journal printers for the hospitality feature and also as an output device for Call Detail Recording (CDR).

A572 printer can function as a CDR device, system printer, or journal printer. The options are set with function keys rather than DIP switches. "[Control Panel for 572 Printer](#)" shows the arrangement of the function keys on the printer control panel.

1. Load the printer with paper and turn the power off (Callout 1).
2. Simultaneously press and hold the **Print Quality** and **On Line** buttons. Press the **Power On** button. Release all three buttons. The printer is now in set-up mode and it prints current settings:
3. If the printer is used as the system printer, set the options as shown in "[572 Printer Used as System Printer](#)".
4. Use **Line Feed** or **Form Feed** to step through the options for the function.
5. Press **On Line**. This activates the menu for the function. Use **Line Feed** and **Form Feed** to step through the options for the function.
6. When a desired option is located, press **Print Quality**. Each time an option is set, the setting is printed. Repeat for each option to be set.
7. When finished, press **Print Quality**. The printer changes to normal mode.

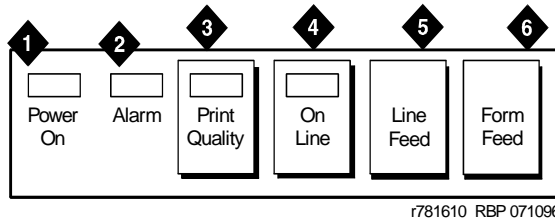

r781610 RBP 071096

Figure Notes

- | | |
|-------------------------|---------------------|
| 1. Power On Button | 4. On Line Button |
| 2. Alarm Button | 5. Line Feed Button |
| 3. Print Quality Button | 6. Form Feed Button |

Control Panel for 572 Printer

572 Printer Used as System Printer

Function	Function Name	Menu	Menu Status
01	FORM LENGTH	09	11
02	LPI	01	6
03	CPI	01	10
04	LQ or NLQ	01	LQ
05	BUZZER	01	ON
06	FONT	02	FONTCART
07	RESOLUTION	01	144
11	BUFFER	02	N-LINE
13	PW ON MODE	01	ON-LINE
14	DIRECTION	01	B1-DIR.1
15	BUFF FULL	02	LF + CR
16	P.E.	01	ACTIVE
17	AUTO CARRIAGE RETURN (CR)	01	CR + LF
18	ZERO	01	0
22	AUTO LINE FEED	01	CR ONLY

572 Printer Used as System Printer — Continued

Function	Function Name	Menu	Menu Status
31	1" SKIP	01	OFF
32	CHAR.SET (GO, GL)	02	USA
33	CHAR.SET (G1, GR)	01	UK
34	CHAR SET (G2)	03	GE
35	CHAR SET (G3)	07	LINE DRAWING
81	OFF-LINE STATE	01	ALL RECEIVE
82	DSR	02	OFF
83	REQUEST TO SEND (RTS) TIMING	01	RTS
84	CD	02	OFF
85	CLEAR TO SEND (CTS)	02	OFF
91	OVER RUN	02	256
92	DATA BIT	02	8
93	PROTOCOL	03	XON/XOFF
94	STOP BIT	01	1
95	PARITY	01	NONE
96	PBS	04	1200

G600 Media Gateway Carrier ID Address

The G600 Media Gateway has a carrier ID address, depending on its location in the rack. The media gateway are "lettered" bottom to top as A, B, C, D. Set the Carrier Address ID either before or after installing each media gateway. You must remove the fan assembly to get to the switches. See "[Fan assembly removal](#)".

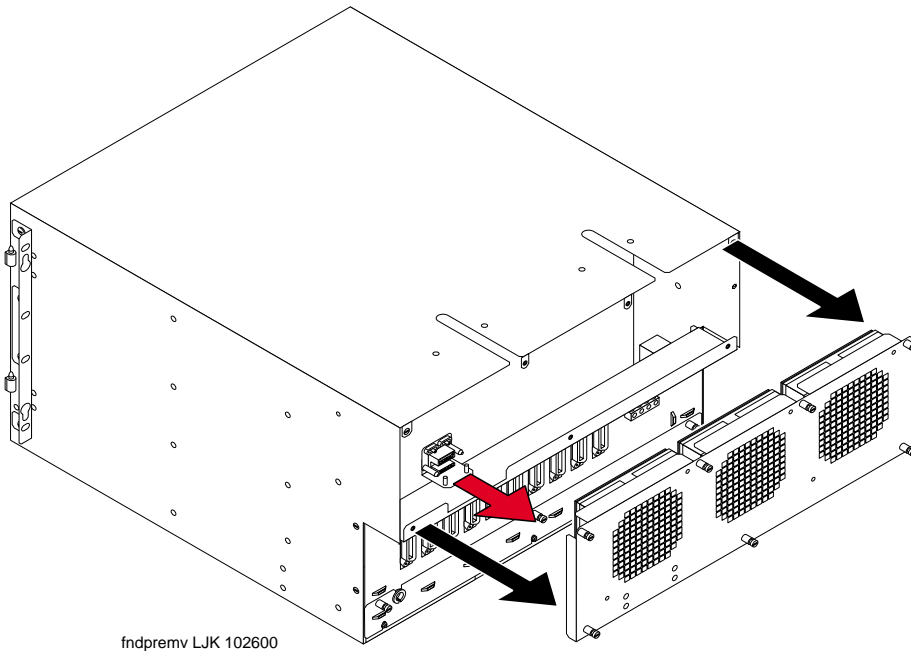

Fan assembly removal

Set the carrier address ID for each media gateway as shown in "[Setting media gateway address ID](#)".

- "A" settings are for the media gateway in the A location
- "B" settings are for the media gateway in the B location
- "C" settings are for the media gateway in the C location
- "D" settings are for the media gateway in the D location
- "E" settings are not used in this configuration.

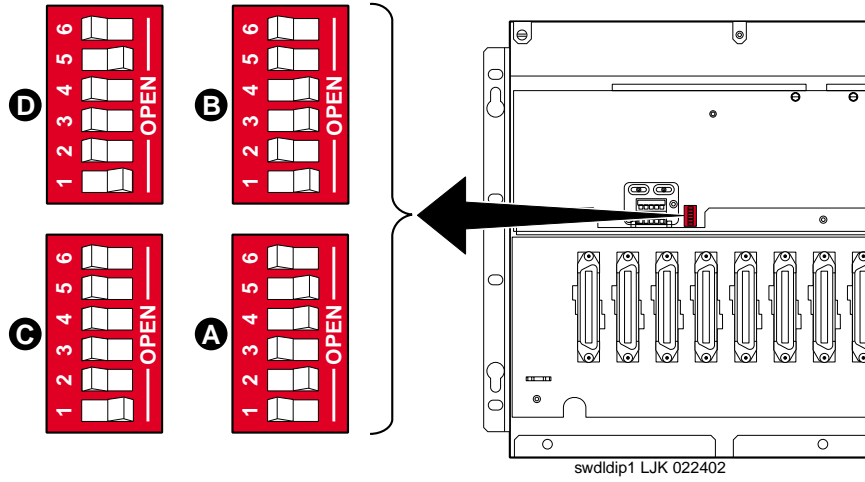

Setting media gateway address ID

TN760D Tie Trunk Circuit Pack Option Settings

The TN760D Tie Trunk circuit pack interfaces between the tie trunks and the Time Division Multiplex (TDM) bus. Two tip and ring pairs form a 4-wire analog transmission line. An E and M pair is used for signaling and are DC signaling leads used for call setup. The E lead receives signals from the tie trunk and the M lead transmits signals to the tie trunk.

To choose the preferred signaling format (“[Signaling Formats for TN760D](#)” and “[Signaling Type Summary](#)”), set the switches on the TN760D and administer the port per “[TN760D Tie Trunk Circuit Pack \(Component Side\)](#)” and “[TN760D Option Switch Settings and Administration](#)”.

CAUTION:

To prevent damage from static electricity, wear an EMC wrist strap when handling circuit packs or other components.

Signaling Formats for TN760D

Mode	Type
E & M	Type I Standard (unprotected)
E & M	Type I Compatible (unprotected)
Protected	Type I Compatible, Type I Standard
Simplex	Type V
E & M	Type V
E & M	Type V Revised

Signaling Type Summary

Signaling Type	Transmit (M-Lead)		Receive (E-Lead)	
	On-Hook	Off-Hook	On-Hook	Off-Hook
Type I Standard	grd	bat	open ¹ /bat	grd
Type I Compatible	open ¹ /bat	grd	grd	open ¹ /bat
Type V	open ¹ /bat	grd	open	grd
Type V Reversed	grd	open	grd	open

1. An open circuit is preferred instead of battery voltage.

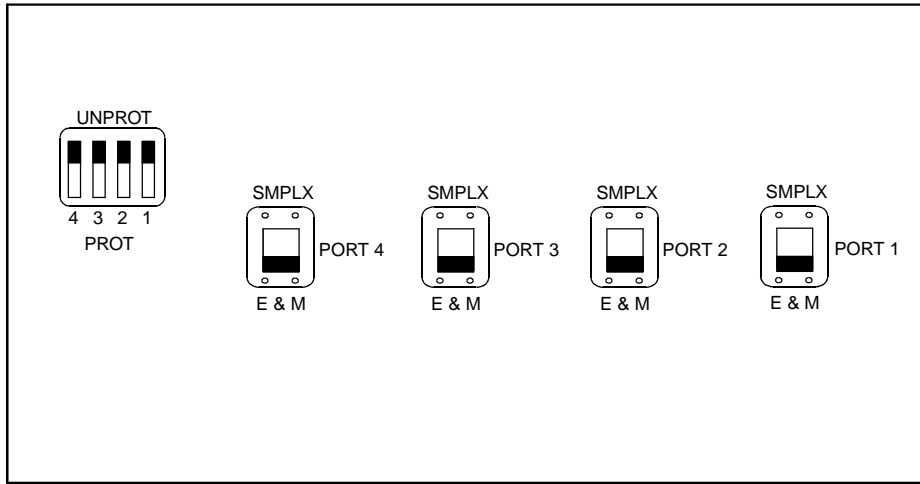

r758183 RBP 050896

TN760D Tie Trunk Circuit Pack (Component Side)

TN760D Option Switch Settings and Administration

Installation Situation		Preferred Signaling Format		Set E&M/ SMPLX Option Switch	Set Prot/ Unprot Option Switch	Administered Port
Circumstance	To	System	Far-End			
Co-Located	Sys75/G1	Simplex	Simplex	SMPLX	Either	Type 5
		Type 5	Type 5			
Inter-Building	Sys75/G1	Simplex	Simplex	SMPLX	Either	Type 5
		Type 5	Type 5			
Co-Located	Sys85/G2	Simplex	Simplex	SMPLX	Either	Type 5
		Type 5	Type 5			
Inter-Building	Sys85/G2	Simplex	Simplex	SMPLX	Either	Type 5
		Type 5	Type 5			
Co-Located	DIMENSION	E&M Type 1	E&M Type 1	E&M	Unprotected	Type 1
	PBX	Compatible	Standard			Compatible
Inter-Building	DIMENSION	Protected Type 1	Protected Type 1	E&M	Protected	Type 1
	PBX	Compatible	Standard			Compatible

Job Aid

TN760D Option Switch Settings and Administration — *Continued*

Installation Situation		Preferred Signaling Format		Set E&M/ SMPLX Option Switch	Set Prot/ Unprot Option Switch	Administered Port
Circumstance	To	System	Far-End			
Co-Located	Other	E&M Type 1	E&M Type 1	E&M	Unprotected	Type 1
		Compatible	Standard			Compatible
Inter-Building	Other	Protected Type 1	Protected Type 1	E&M	Protected	Type 1
		Compatible	Standard Plus			Compatible
			Protection Unit			
Co-Located	Net Integrated	E&M Type 1	Any PBX	E&M	Unprotected	Type 1
		Standard				

TN464/2464 Option Settings

The TN464/2464 DS1/E1 Interface-T1/E1 circuit pack interfaces between a 24 or 32 channel CO/ISDN or tie trunk and the Time Division Multiplexing (TDM) bus.

Set the switches on the circuit pack to select bit rate and impedance match. See [“Option Switch Settings on TN464/2464”](#) and [“TN464/2464 Option Settings”](#).

Option Switch Settings on TN464/2464

120 ohms	Twisted pair
75 ohms	Coaxial requiring 888A adapter
32 channel	2.048 Mbps
24 channel	1.544 Mbps

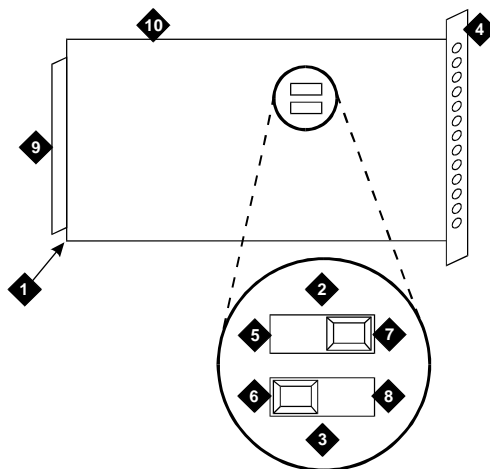

Figure Notes

- | | |
|---------------------------|--------------------------------|
| 1. Backplane Connectors | 6. 120 ohm (shown selected) |
| 2. 24/32-Channel Selector | 7. 24 Channel (shown selected) |
| 3. 75/120-ohm Selector | 8. 75 ohm |
| 4. Faceplate | 9. Connector |
| 5. 32 Channel | 10. TN464/2464 |

TN464/2464 Option Settings

